

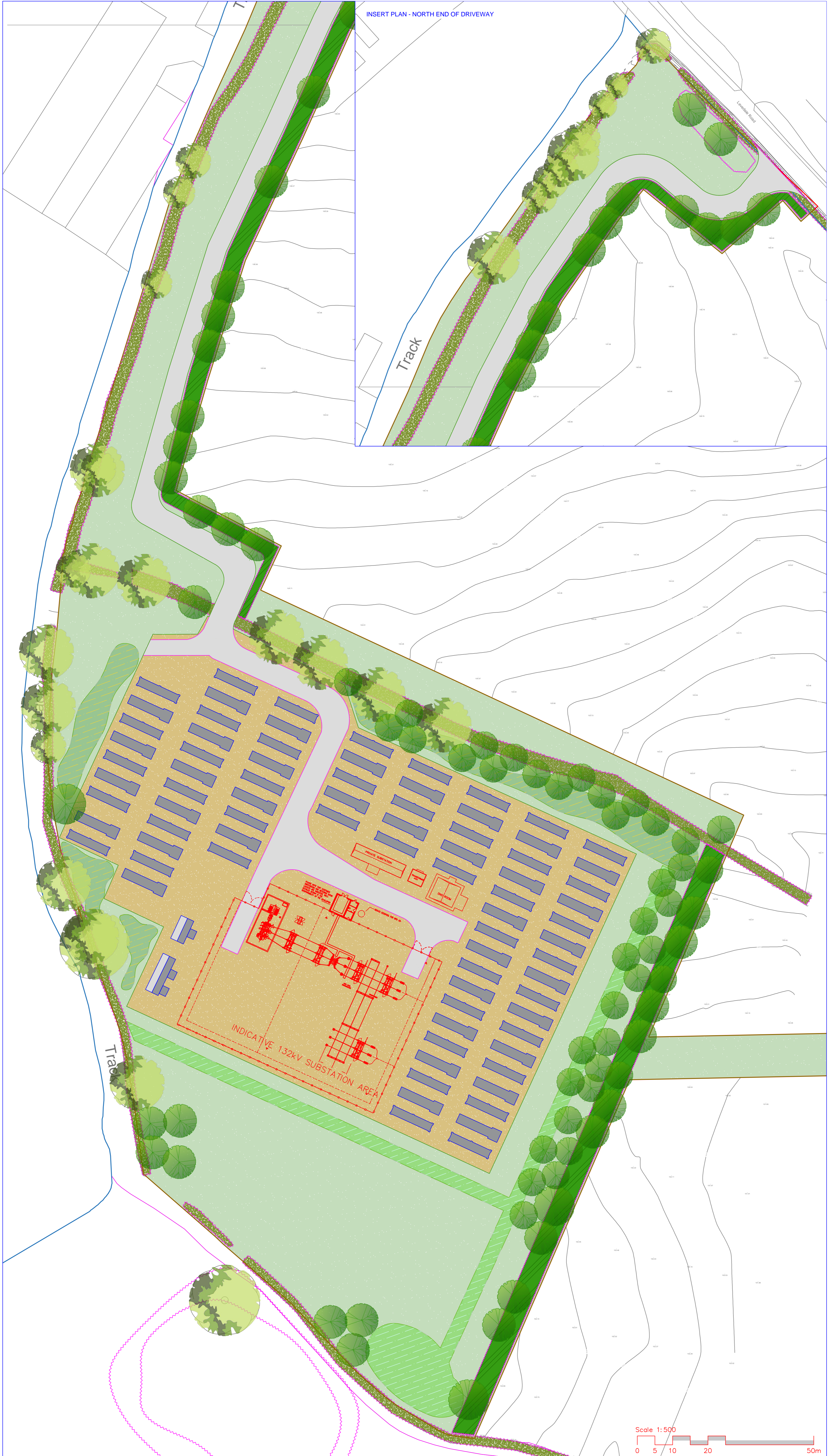

INSERT PLAN - NORTH END OF DRIVEWAY

- LANDSCAPE KEY**
-  SITE BOUNDARY
 -  LAND IN CLIENTS CONTROL
 -  PROPOSED BUILDING LINE
 -  PROPOSED TREE
To be selected from the following:
Prunus Avium
Quercus Robur
Alnus Glutinosa
Prunus Malus
 -  EXISTING TREE
 -  EXISTING HEDGE
 -  PROPOSED HEDGEROW PLANTING
Crataegus monogyna,
Prunus spinosa,
Alnus glutinosa,
Corylus avellana,
Rosa canina,
Ilex aquifolium,
Sambucus nigra,
Fagus sylvatica
 -  AMENITY TURF AREA
Suggested seed mixture:
Emorsgate- EG10 'Tussock Grass Mixture' or similar
 -  WILDFLOWER SEED MIX
Suggested seed mixture:
Emorsgate- EM2 'Standard General Purpose Meadow Mixture' or similar
 -  WILDFLOWER SEED MIX
Suggested seed mixture:
Emorsgate- EM8 'Meadow Mixture for Wetlands' or similar
 -  PERMEABLE GRAVEL MATERIAL
 -  TARMACADAM SURFACE
Supplier: To Engineers Specification
 -  SELF BINDING GRAVEL PATHWAY
 -  SINGLE GATE ACCESS WITH PALISADE FENCE



P12 10.10.2023 Update Plan ZX
P11 10.10.2023 Update Key ZX
P10 01.08.2023 Add Trees ZX
P09 30.06.2023 Building updated ZX
P08 23.06.2023 Hedge Changes, Spine road moved DC
P07 22.06.2023 Update New Plan ZX
revision / date / description / drawn

Gloucester House,
399 Silbury Boulevard,
Milton Keynes,
Buckinghamshire
MK9 2AH
T 01908 303701
W www.enplan.net



client	-
project	Land on the Leavedale Road Staffordshire
scale	1:500@A1
date	Oct 2022
title	General Arrangement
drawn	ZX
checked	DC
revision	P12
drawing number	05-1095-301
issue	S3 - Suitable for Review & Comment

